



[www.nortalu.pt](http://www.nortalu.pt)



**SÉRIE BL**



## SÉRIE BL

### SISTEMA GRADEAMENTOS GLASSGUARD E TRADICIONAL

**Sistema GlassGuard**, elegante, minimalista e vanguardista. Orientado para a arquitetura moderna, para além da segurança é esteticamente agradável à vista, mantendo uma funcionalidade simples.

**Sistema Tradicional** onde permite a execução de gradeamentos e corrimões de forma a corresponder às necessidades de qualquer tipo de habitação.

#### Resultados do Ensaio do Tipo Inicial:

	Locais de actividade Residencial Fixações a cada 200mm	Locais de actividade Residencial Fixações a cada 400mm	Locais de acolhimento público Fixações a cada 400mm
Ensaio Nº OEF039/13 de 06-11-2013	APTO		
Ensaio Nº OEF040/13 de 06-11-2013		APTO	
Ensaio Nº OEF041/13 de 06-11-2013			APTO

Guarda alumínio do Sistema GlassGuard(AV)

Dimensão da Janela:

2500\*1100mm

#### Soluções Construtivas:

- Gradeamentos

#### Capacidade de Vidro:

- Vidro : 12 a 20mm

#### Vedantes:

- Material em EPDM ou PVC em conformidade com a norma aplicável.

#### Acessórios:

- Materiais em alumínio, zamac, aço inox e nylon em conformidade com a norma aplicável.



## BL - GlassGuard

**BL.35** *Guarda de Vidro*

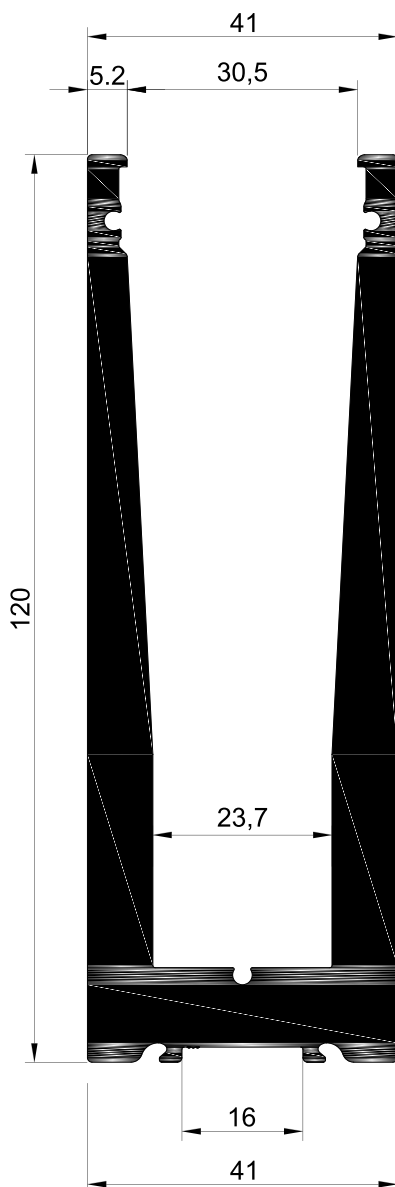

**BL.46** *Guarda de Vidro C/ Furação Inferior*

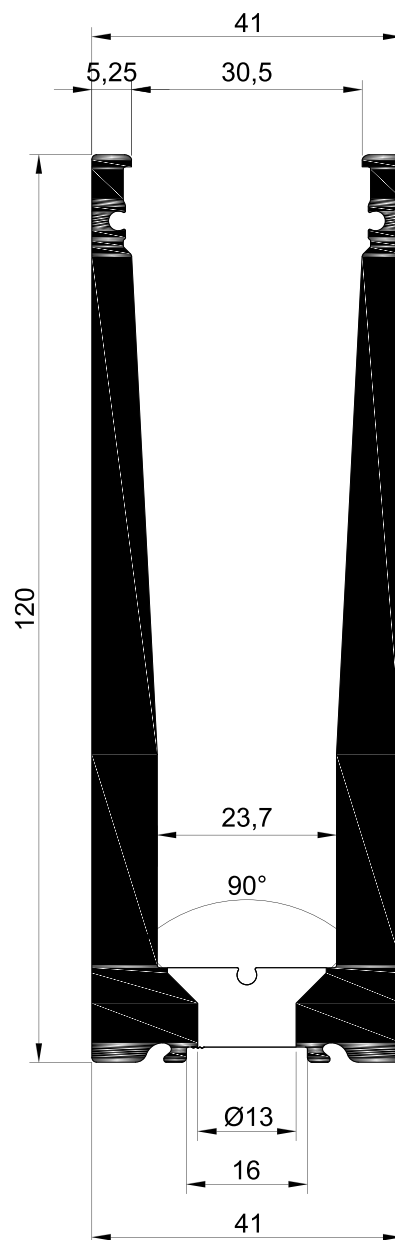

**BL.47** *Guarda de Vidro C/ Furação Lateral*

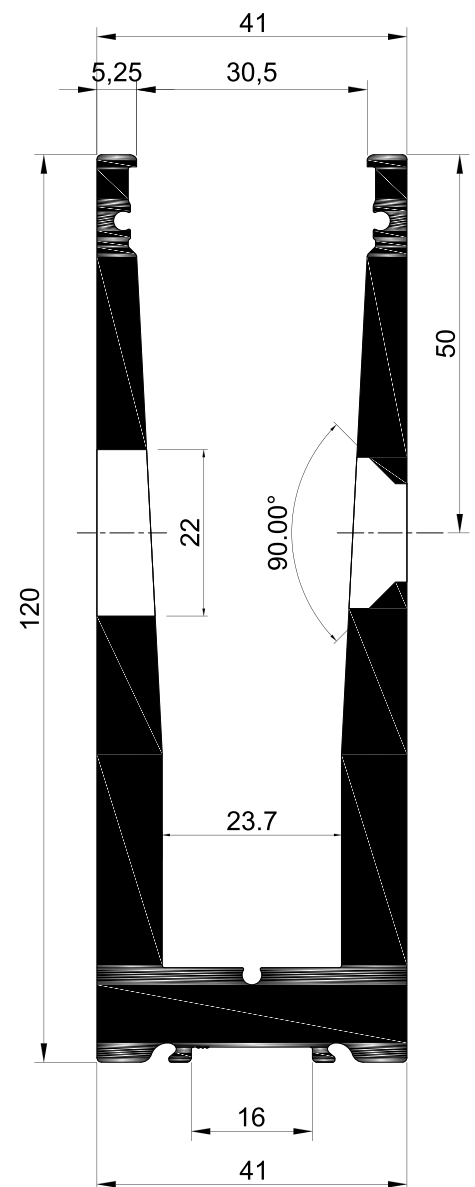

**BL.53** *Guarda de Vidro*

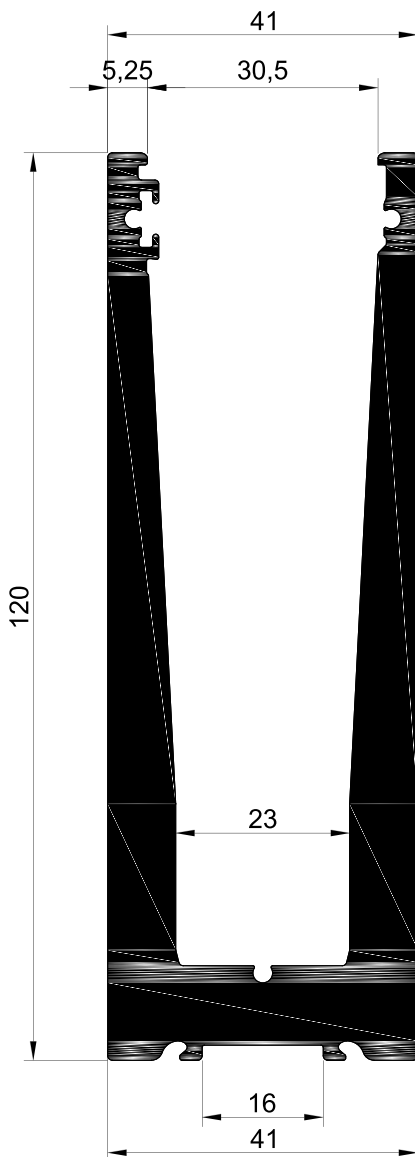

**BL.54** *Guarda de Vidro C/ Furação Inferior*

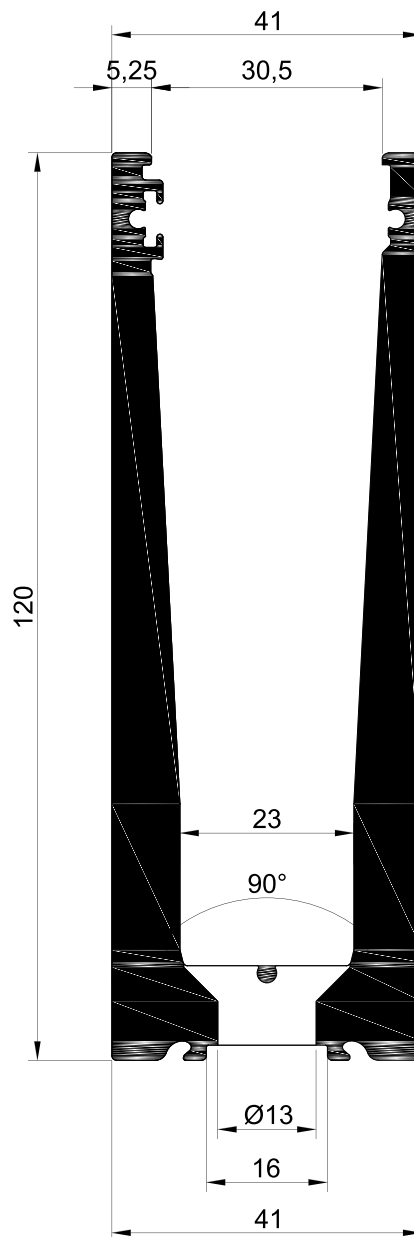

**BL.55** *Guarda de Vidro C/ Furação Lateral*

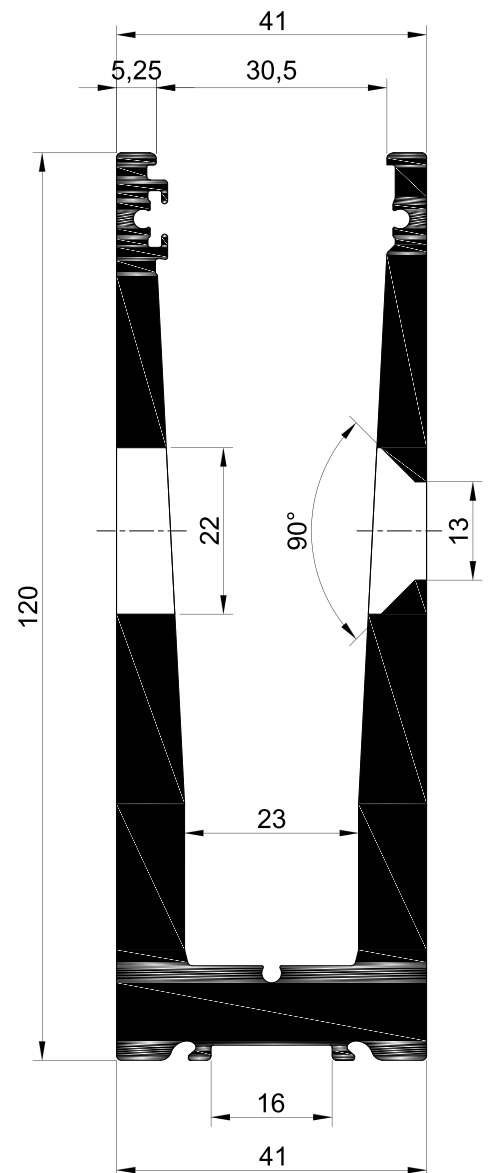

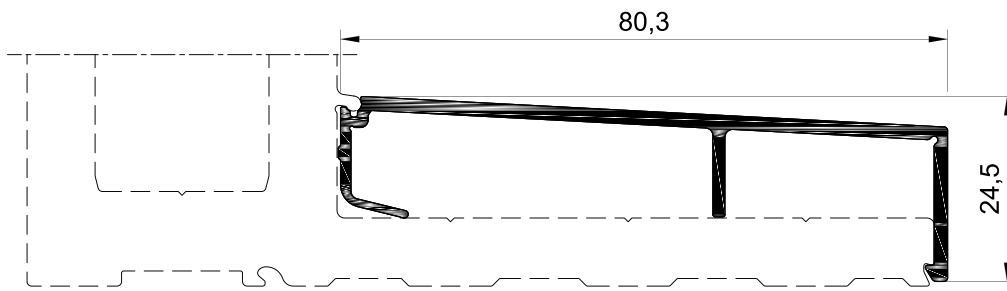

**BL.49** Remate P/ BL.45

**BL.45** Guarda de Vidro  
C/ Remate Lateral

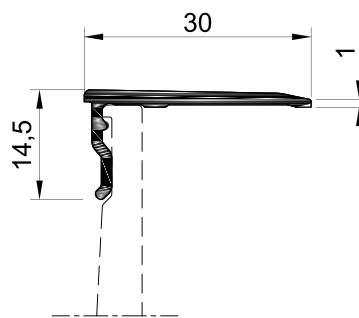

**BL.48** Remate P/ Chão

**BL.36** Remate para  
Furação Lateral

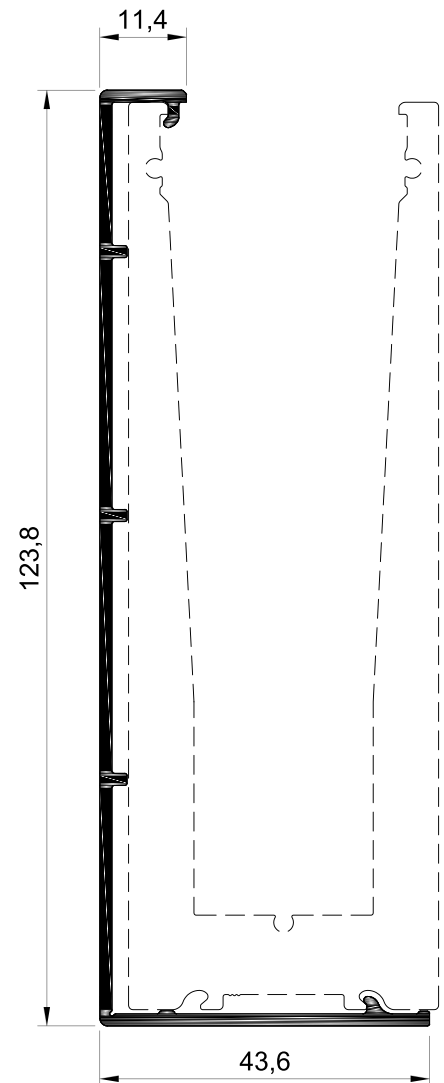

**BL.50** *Passa-Mãos Standard*

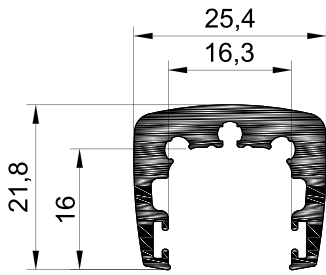

**BL.51** *Passa-Mãos Standard*

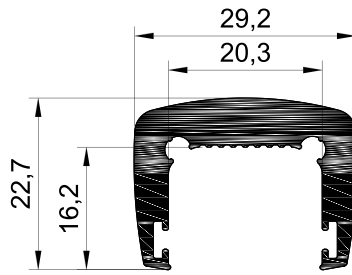

**BL.52** *Passa-Mãos Standard*

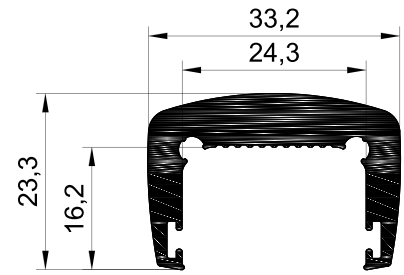

**U.32** *Perfil U 18\*9\*2mm*

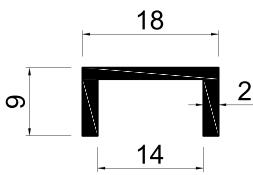

**U.33** *Perfil U 22\*9\*2mm*

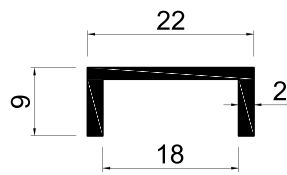

**U.34** *Perfil U 26\*9\*2mm*

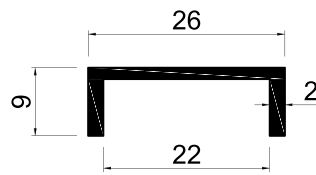

**U.20** *Perfil U 13\*15\*1.5mm*

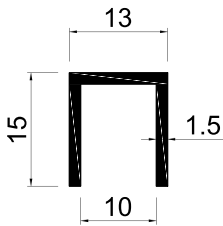

**U.21** *Perfil U 15\*15\*1.5mm*

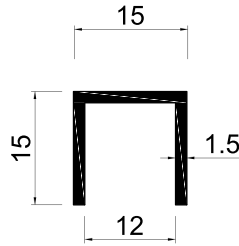

**U.08** *Perfil U 18\*15\*1.5mm*

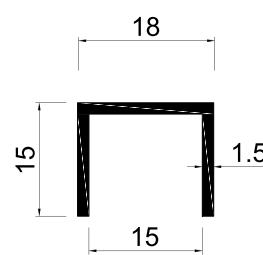

**U.23** *Perfil U 23\*15\*1.5mm*

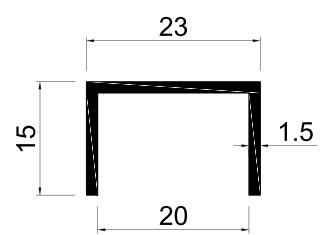

**U.22** *Perfil U 20\*20\*1.5mm*

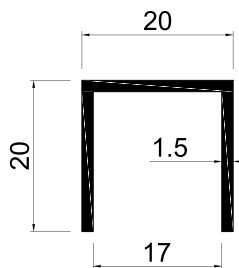

**U.30** *Perfil U 22.4\*20\*1.5mm*

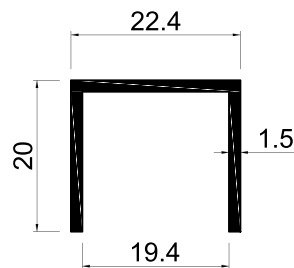

**U.31** *Perfil U 26\*26\*1.5mm*

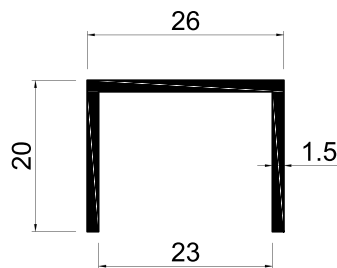

**U.24** *Perfil U 13\*25\*1.5mm*

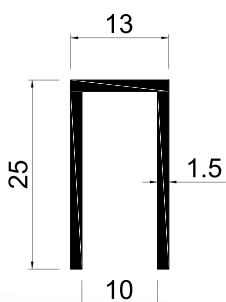

**U.25** *Perfil U 15\*25\*1.5mm*

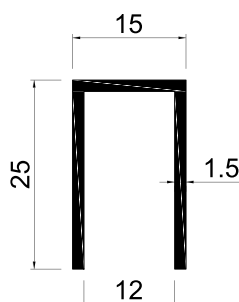

**U.26** *Perfil U 18\*25\*1.5mm*

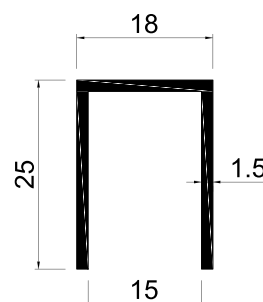

**U.27** *Perfil U 23\*25\*1.5mm*

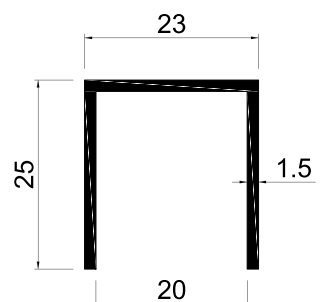

## BL - Tradicional

**BL.15** *Corrimão 103*

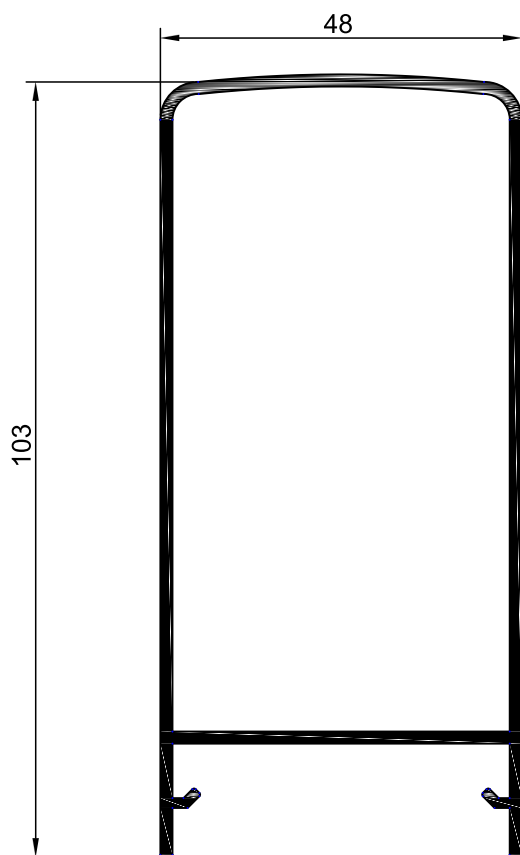

**BL.25** *Corrimão 80*

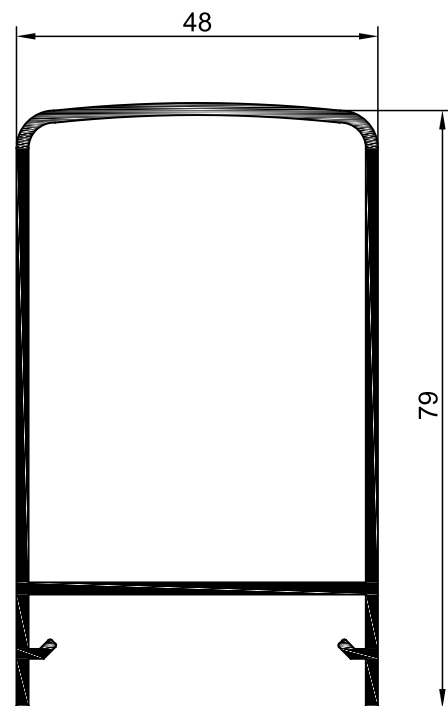

**BL.16** *Corrimão*

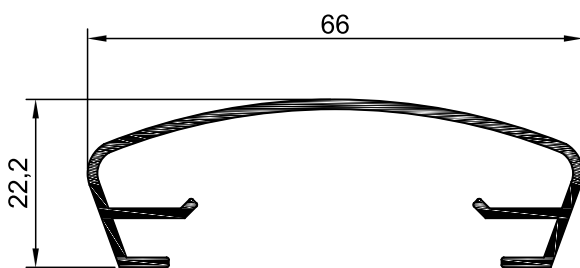

**BL.31** *Corrimão*

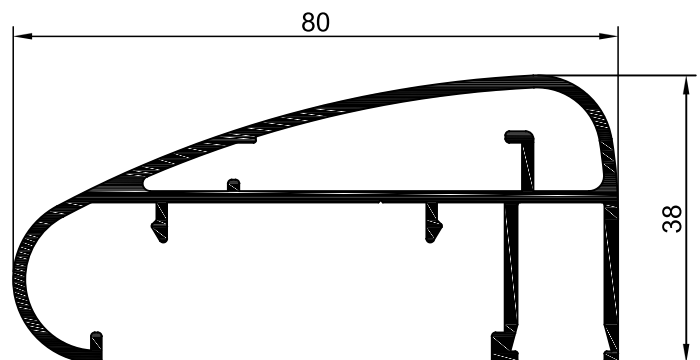

**BL.27** *Corrimão*

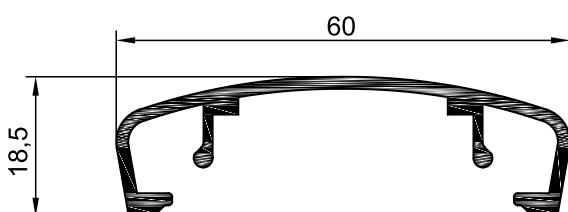

**BL.34** *Corrimão*

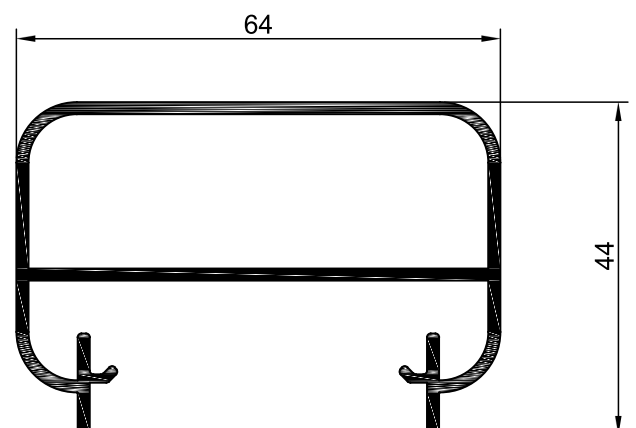

**BL - Tradicional**

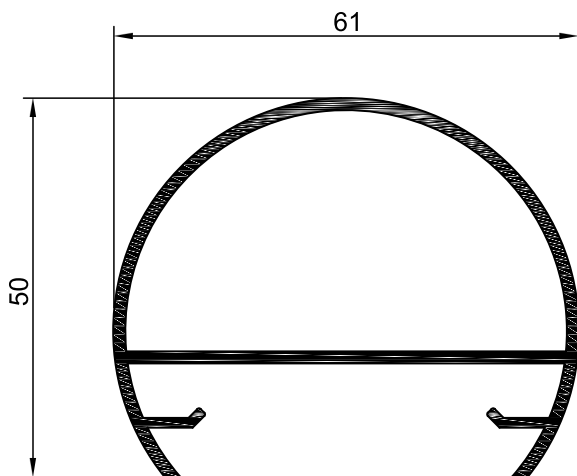

**BL.26** *Corrimão Bola*

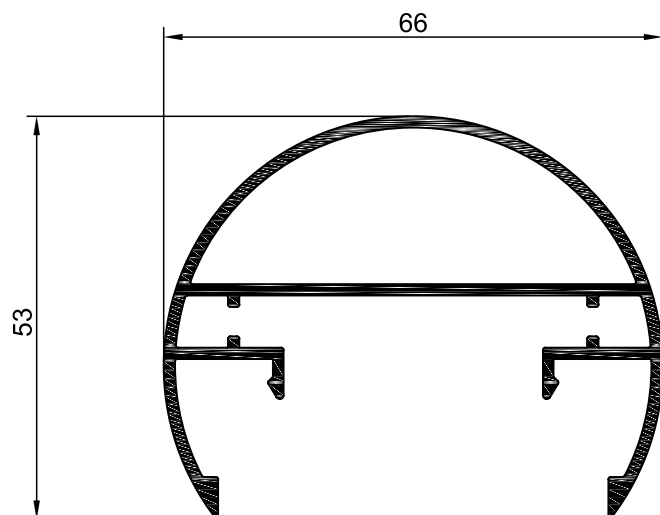

**BL.22** *Corrimão Bola*

**BL.30** *Clip Receptor*

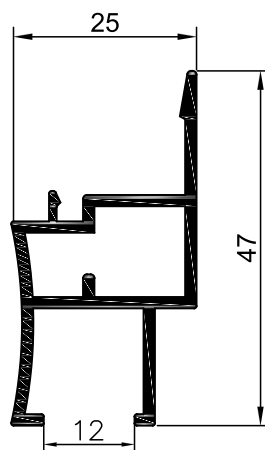
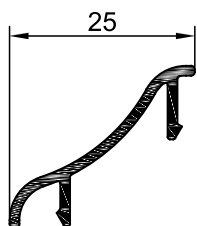

**BL.29** *Receptor Vidro*



BL - Tradicional

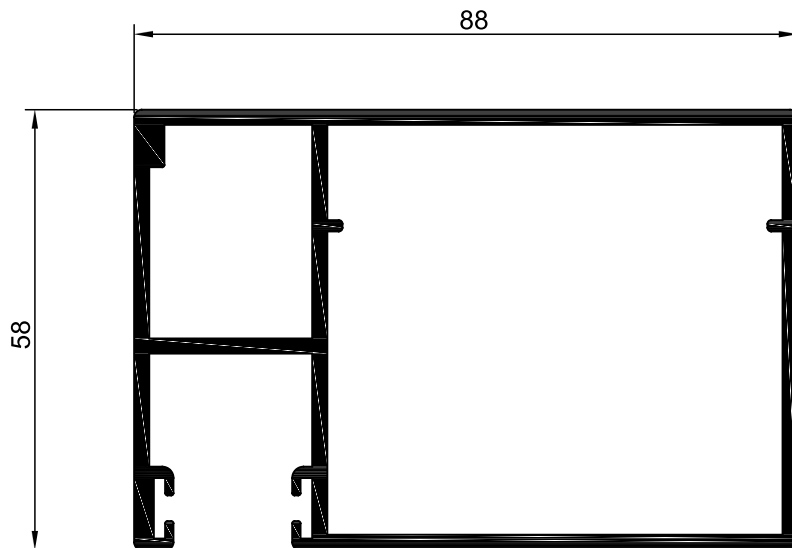

**BL.23** *Corrimão C/ Vidro*

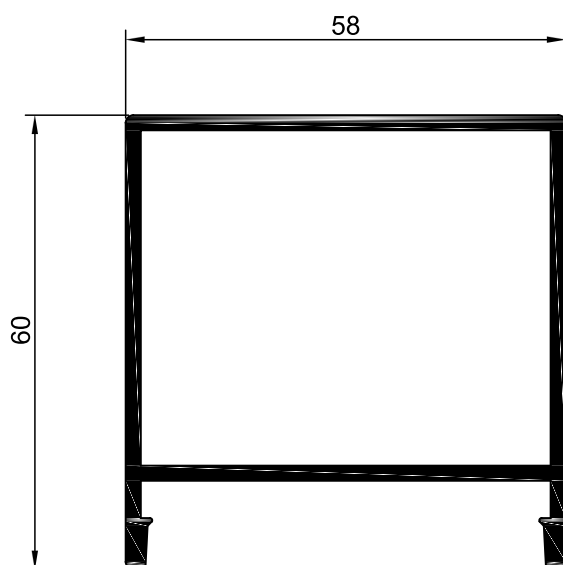

**BL.24** *Corrimão*

## BL - Tradicional

**BL.17** *Capa Inferior*

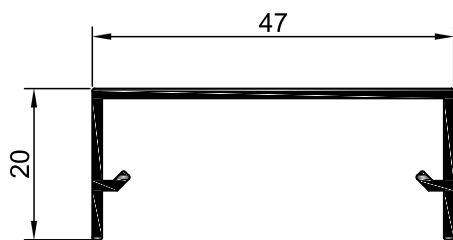

**BL.19** *Capa Inferior*

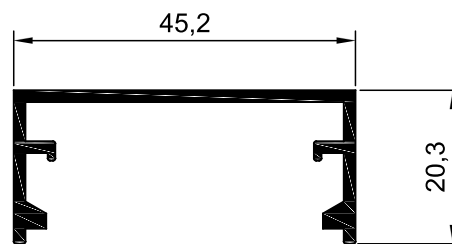

**BL.20** *Sub-Capa*

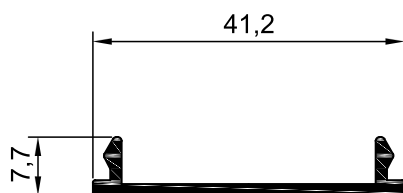

**BL.18** *Sub-Capa*

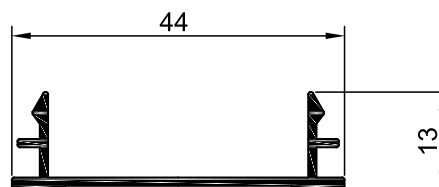

**BL.21** *Sub-Capa*

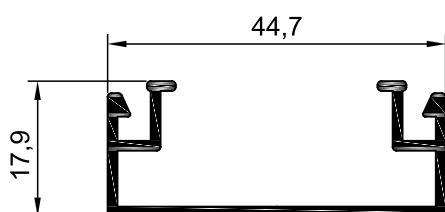

**BL.43** *Sub-Capa*

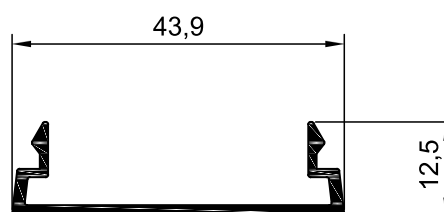

**BL.33** *Sub-Capa*

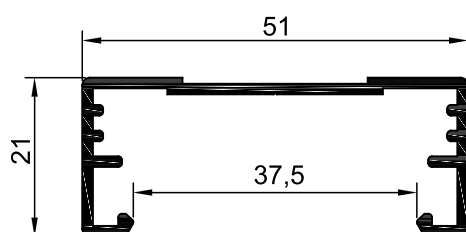

**BL.28** *Sub-Capa*

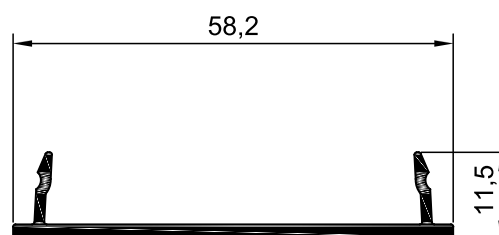

## BL - Tradicional

**BL.13** *Prumo Vertical*

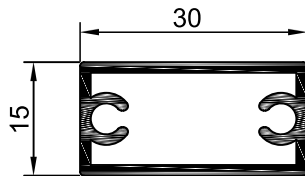

**BL.11** *Prumo Vertical*

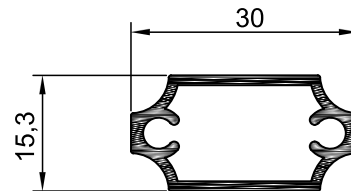

**BL.12** *Prumo Vertical*

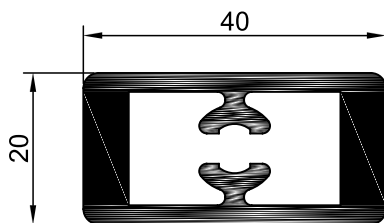

**BL.14** *Prumo Vertical*

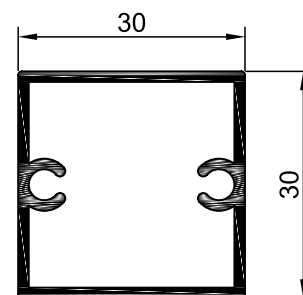

**BL.32** *Receptor Vidro*

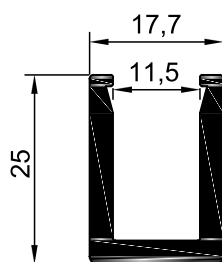

**BL.44** *Prumo Vertical*

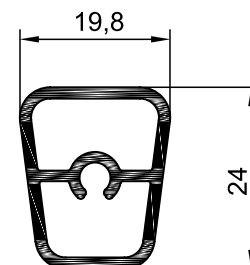





**NORTALU<sup>®</sup>**

**ACESSÓRIOS**



### JUNTAS E PERFIS PARA VIDRO DE 12MM

GASKETS AND PROFILES FOR 12MM GLASS | JOINTS ET PROFILÉS POUR VERRE 12MM

Aconselha-se vidro Laminado Temperado c/ HST ou Termoendurecido

Tempered w/ HST or Heat strengthened Laminated glass is advised | Le verre Feuilleté Trempé ou Termodurci est conseillé

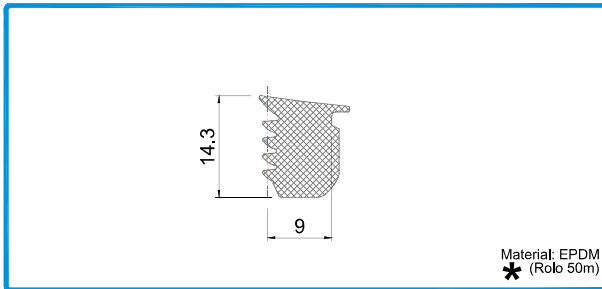

208198

JUNTA VD 5009

Material: EPDM  
\* (Rolo 50m)

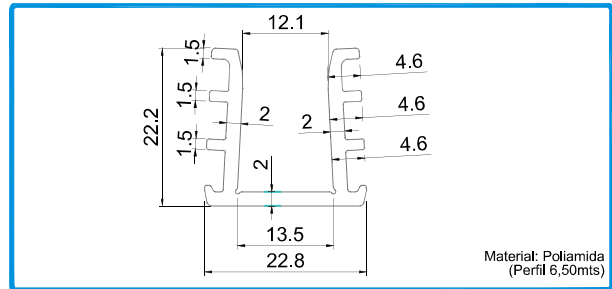

208162

PERFIL 5019

Material: Poliamida  
(Perfil 6,50mts)

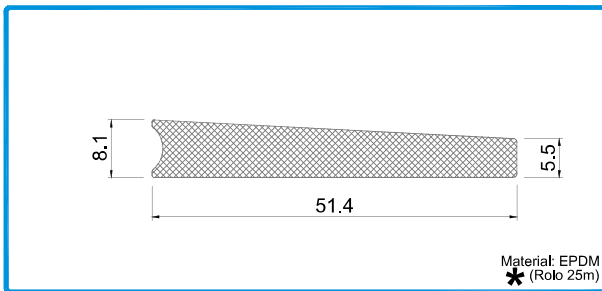

208163

JUNTA VD 5029

Material: EPDM  
\* (Rolo 25m)

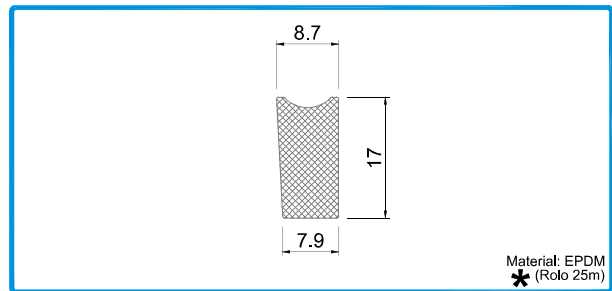

208164

JUNTA VD 5039

Material: EPDM  
\* (Rolo 50m)

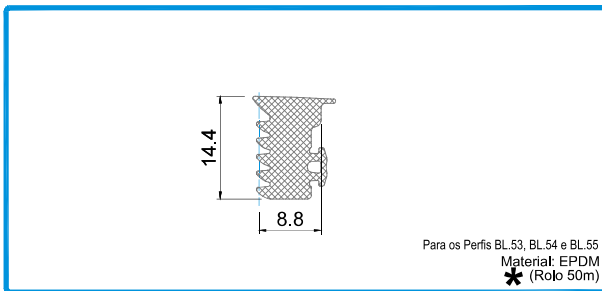

208217

JUNTA VD 5049

Para os Perfis BL.53, BL.54 e BL.55  
Material: EPDM  
\* (Rolo 50m)

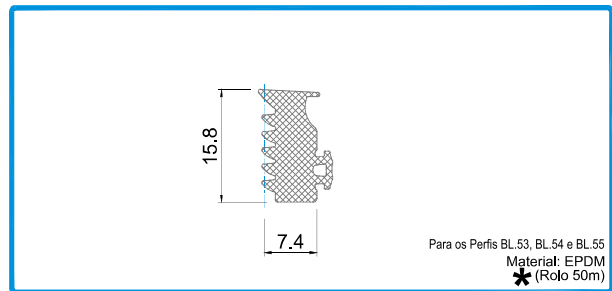

208219

JUNTA VD 5059

Para os Perfis BL.53, BL.54 e BL.55  
Material: EPDM  
\* (Rolo 50m)

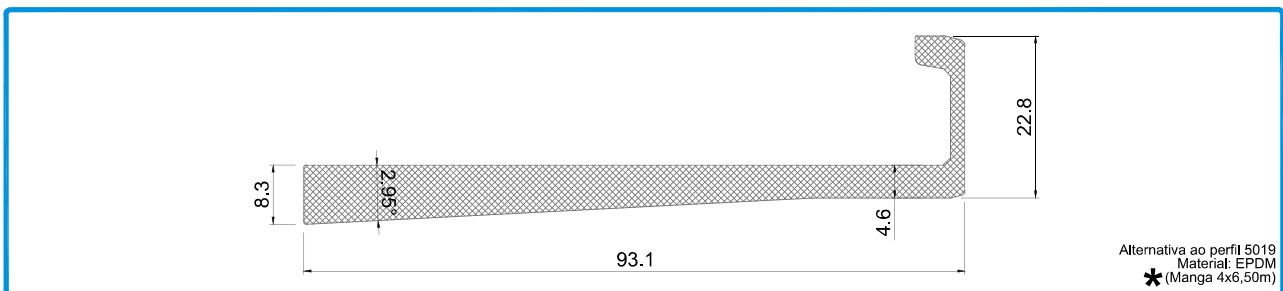

215192

PERFIL VD 5069

Alternativa ao perfil 5019  
Material: EPDM  
\* (Manga 4x6,50m)

## JUNTAS E PERFIS PARA VIDRO DE 16MM

GASKETS AND PROFILES FOR 16MM GLASS | JOINTS ET PROFILÉS POUR VERRE 16MM

Aconselha-se vidro Laminado Temperado c/ HST ou Termoendurecido

Tempered w/ HST or Heat strengthened Laminated glass is advised | Le verre Feuilleté Trempé ou Termoturci est conseillé

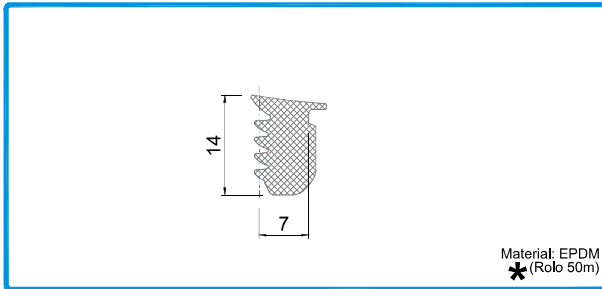

208165

JUNTA VD 5007

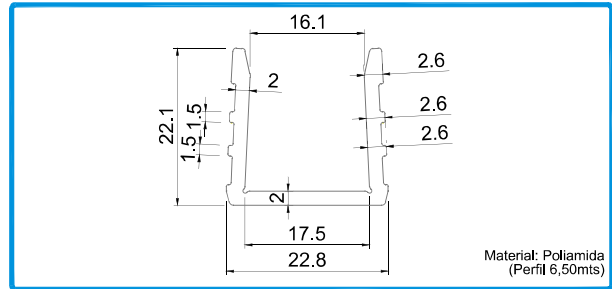

208166

PERFIL 5017

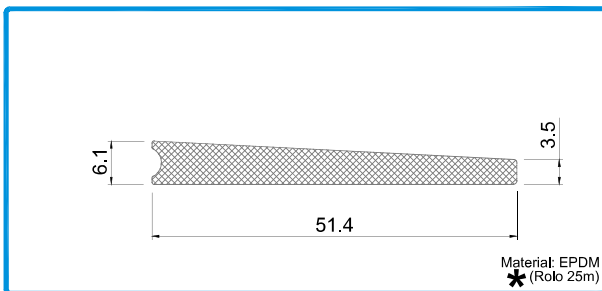

208167

JUNTA VD 5027

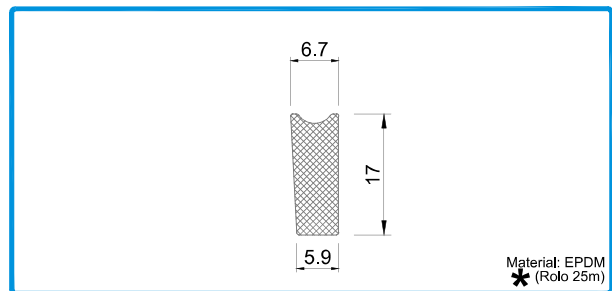

208168

JUNTA VD 5037

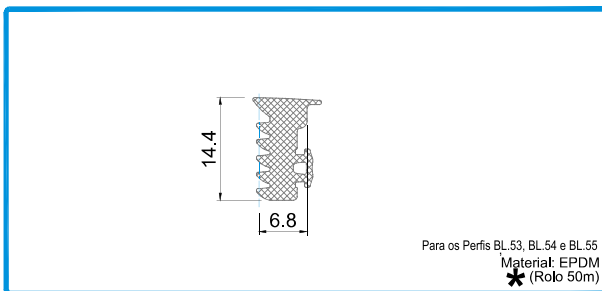

208211

JUNTA VD 5047

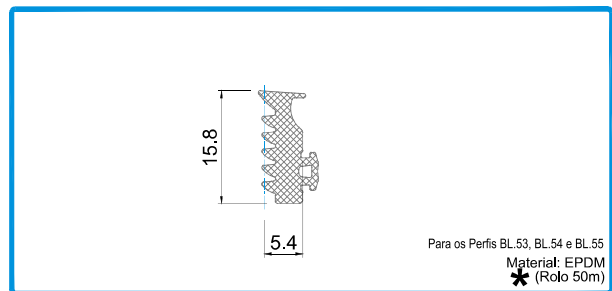

208212

JUNTA VD 5057

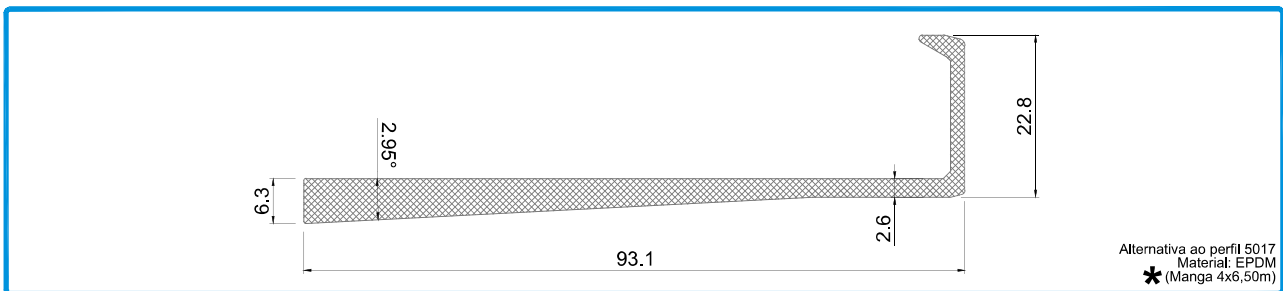

215190

PERFIL VD 5067



## JUNTAS E PERFIS PARA VIDRO DE 20MM

GASKETS AND PROFILES FOR 20MM GLASS | JOINTS ET PROFILÉS POUR VERRE 20MM

Aconselha-se vidro Laminado Temperado c/ HST ou Termoendurecido

Tempered w/ HST or Heat strengthened Laminated glass is advised | Le verre Feuilleté Trempé ou Termodurci est conseillé

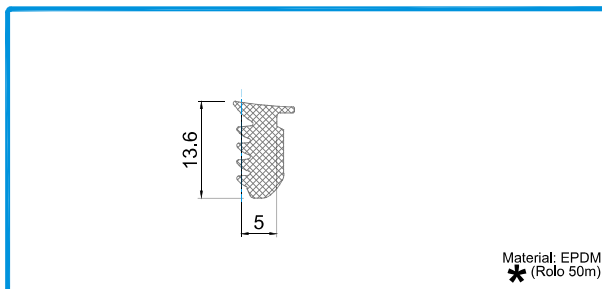

Material: EPDM  
\* (Rolo 50m)

208173

JUNTA VD 5005

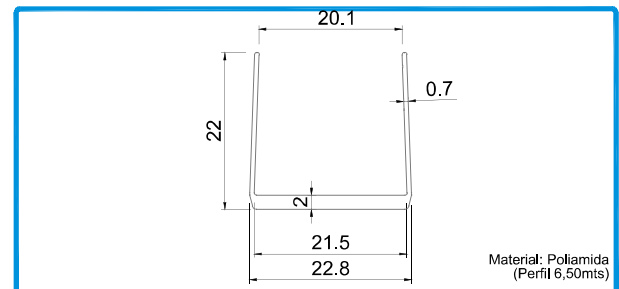

Material: Poliamida  
(Perfil 6,50mts)

208174

PERFIL 5015

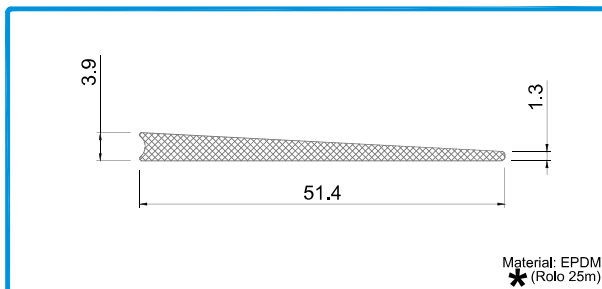

Material: EPDM  
\* (Rolo 25m)

208175

JUNTA VD 5025

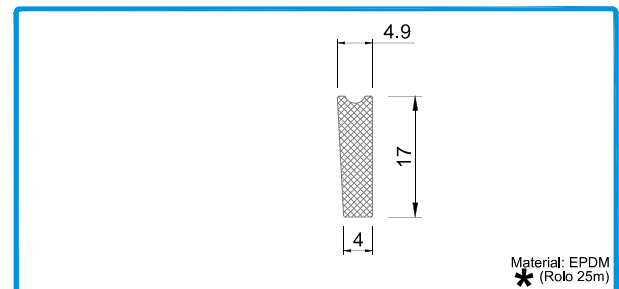

Material: EPDM  
\* (Rolo 25m)

208176

JUNTA VD 5035

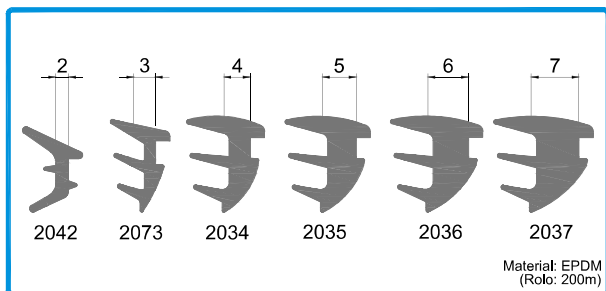

208191 JUNTA DE CUNHA 2042    208215 JUNTA DE CUNHA 2036  
 208195 JUNTA DE CUNHA 2034    208904 JUNTA DE CUNHA 2037  
 208196 JUNTA DE CUNHA 2035    208199 JUNTA DE CUNHA 2073

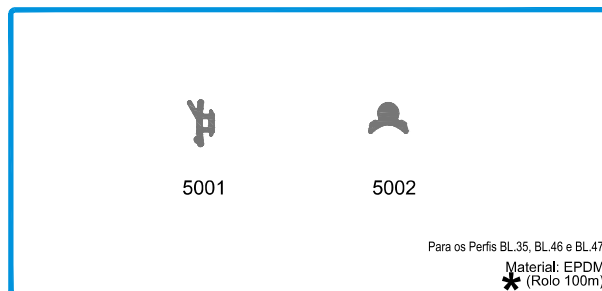

208177 JUNTA VD 5001  
 208178 JUNTA VD 5002

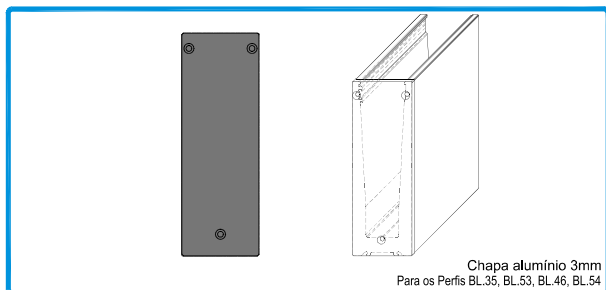

210086 TOPO BL.53

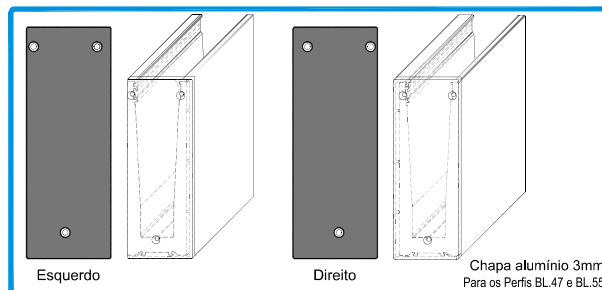

210090 TOPO BL.53 / BL.36 ( Esquerdo )  
 210089 TOPO BL.53 / BL.36 ( Direito )

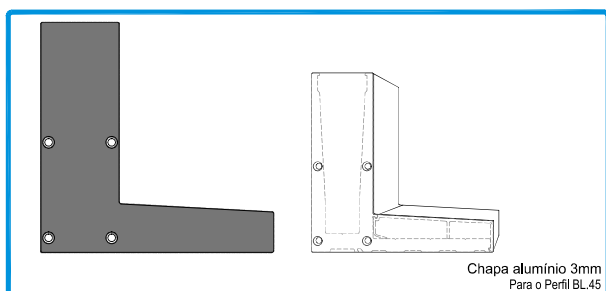

210263 TOPO BL.45 ESQUERDO

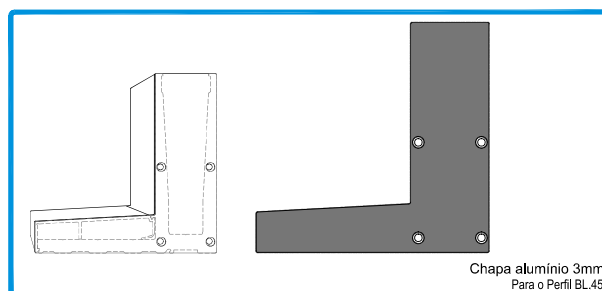

210261 TOPO BL.45 DIREITO

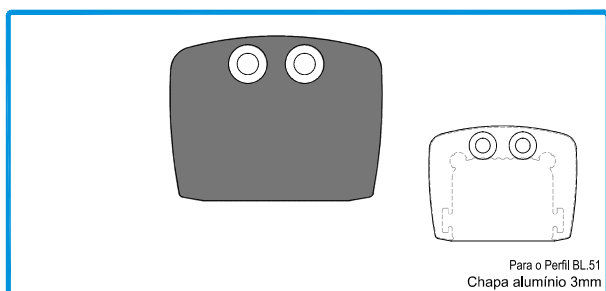

210078 TOPO BL.51

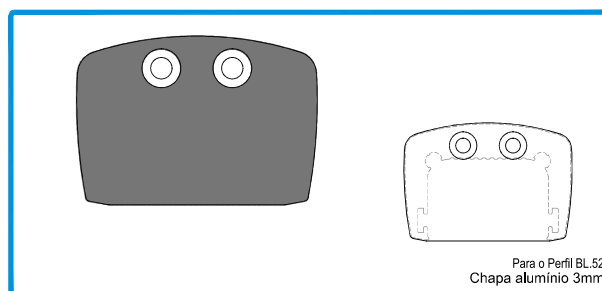

210080 TOPO BL.52

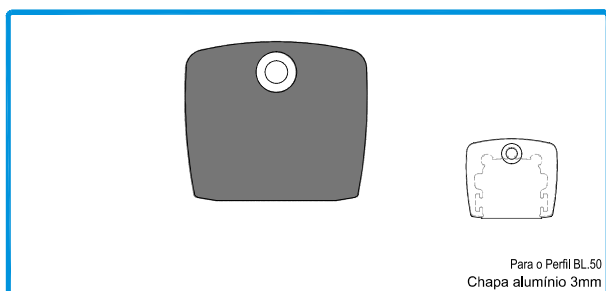

210085 TOPO BL.50



290016 PARAFUSO FIXAÇÃO DE TOPOS

## BL - GLASSGUARD

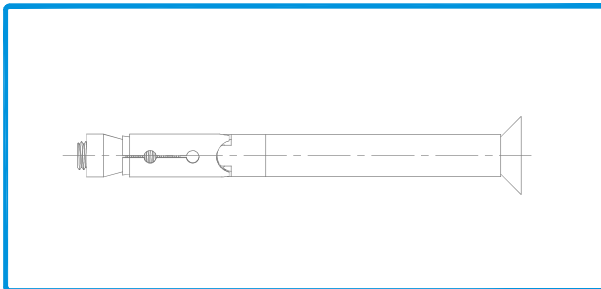

290019 PAR. INO C/ BUCHA GALV. FII 12/50 P/FIXAÇÃO AV-11-12

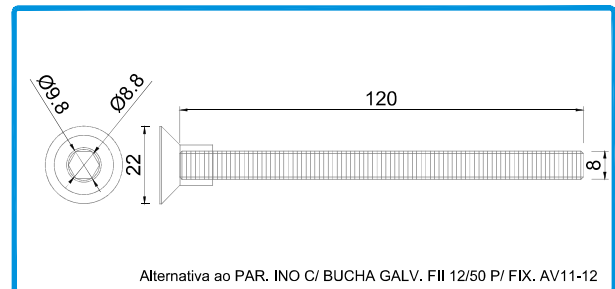

Alternativa ao PAR. INO C/ BUCHA GALV. FII 12/50 P/ FIX. AV11-12

212235 CONJ. FIX. CASQUILHO + VARÃO M8x120MM









Junta de vedação elástica, resistente aos UV, Impede a corrosão de penetrar pelas zonas cortadas.

208019 SELA JUNTAS 150gr. (Cinza)



Limpeza de alumínio lacado ou anodizado. Para preparação das superfícies a serem unidas e limpeza final.

208704 PRODUTO LIMPEZA DE ALUMÍNIO (1L) Transparente



ARTIGO	DESCRIÇÃO	APLICAÇÃO
	<b>L40102</b> Pinça/Suporte Vidro	
	<b>L40103</b> Suporte / Calha Vidro	
	<b>L40104</b> Suporte / Calha Vidro Rotativo	
	<b>L40105</b> Suporte Corrimão Redondo (Tubo 30mm)	
	<b>L40106</b> Suporte Corrimão Quadrado (Tubo 30*30mm e 30*15mm)	
	<b>L40107</b> Suporte Corrimão Rectângular (Tubo 40*20mm)	

BL - TRADICIONAL

ARTIGO	DESCRIÇÃO	APLICAÇÃO
	<b>L40111</b> Fixador Guardas 40*20	
	<b>L40114</b> Sapata C/ Afinação	
	<b>L40115</b> Sapata Central	
	<b>L40116</b> Sapata Central Inclinada	
	<b>L40117</b> Sapata Parede	
	<b>L40120</b> Fixador Guardas	

ARTIGO	DESCRIÇÃO	APLICAÇÃO
	<b>SB02L</b> Sapata Base 30*30	
	<b>SB03L</b> Sapata Base 65*65	
	<b>TAMP A001L</b> Tampa Fixador Guardas	
	<b>RB02L</b> Remate Bola	
	<b>L40132</b> Topo Redondo	
	<b>L40133</b> Topo Recto	

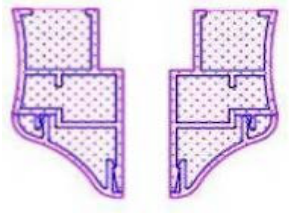
BL - TRADICIONAL

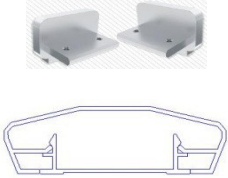
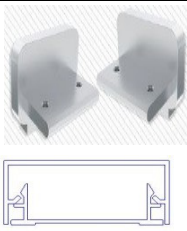
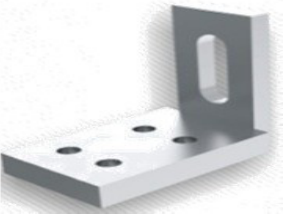
ARTIGO	DESCRIÇÃO	APLICAÇÃO
	<p><b>L40134</b></p> <p>Topo Oval</p>	
	<p><b>L40135</b></p> <p>Topo Calha para Guardas</p>	
	<p><b>L40136</b></p> <p>Topo Recto</p>	
	<p><b>L40139</b></p> <p>Topo Oval</p>	
	<p><b>L40140</b></p> <p>Topo Recto</p>	
	<p><b>L40181</b></p> <p>Topo Recto</p>	

ARTIGO	DESCRIÇÃO	APLICAÇÃO
	<b>L40182</b> Esquadro Afinação 90°	
	<b>L40183</b> Esquadro Angular	
	<b>L40184</b> Esquadro Angular	
	<b>L40185</b> Esquadro Angular	
	<b>L40186</b> Esquadro Angular	





**NORTALU<sup>®</sup>**

**PORMENORES TÉCNICOS**



## CAIXA PARA VIDRO DE 12mm (6.6.2) - COM PERFIS BL.35 | 46 | 47

PORMENOR DO PASSA-MÃO BL.50

PORMENOR DO PASSA-MÃO U.22

PORMENOR DO PASSA-MÃO U.26

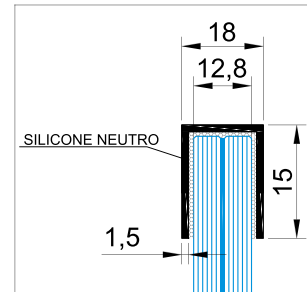
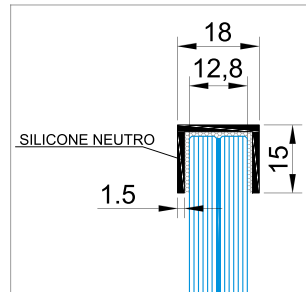
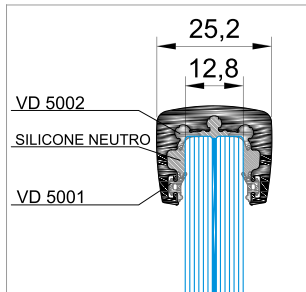

APLICAÇÃO DO SISTEMA NA VERTICAL

APLICAÇÃO DO SISTEMA NA LATERAL

APLICAÇÃO DO SISTEMA EMBUTIDO

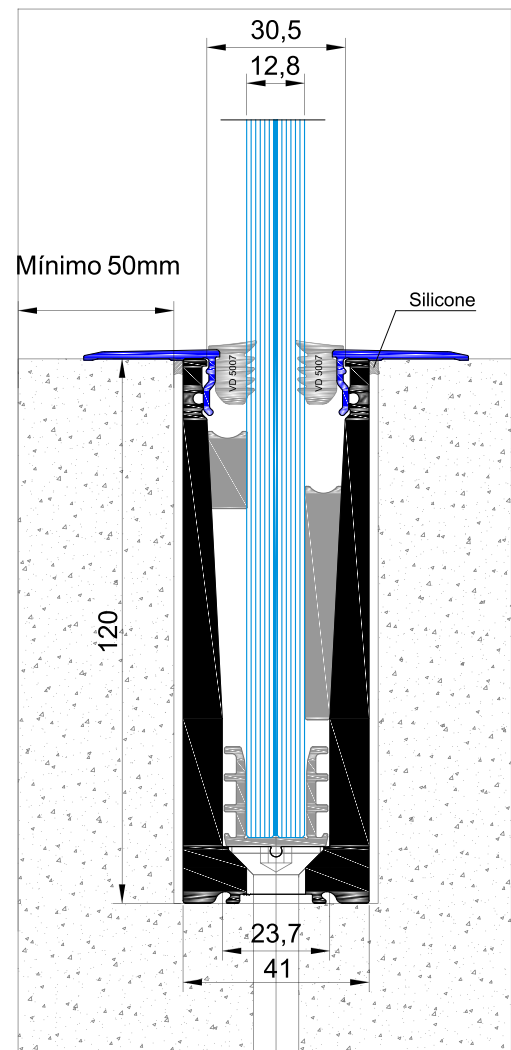
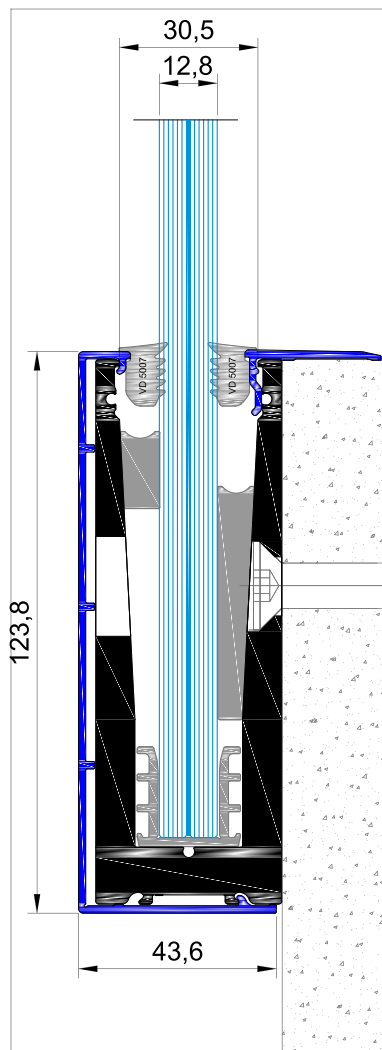
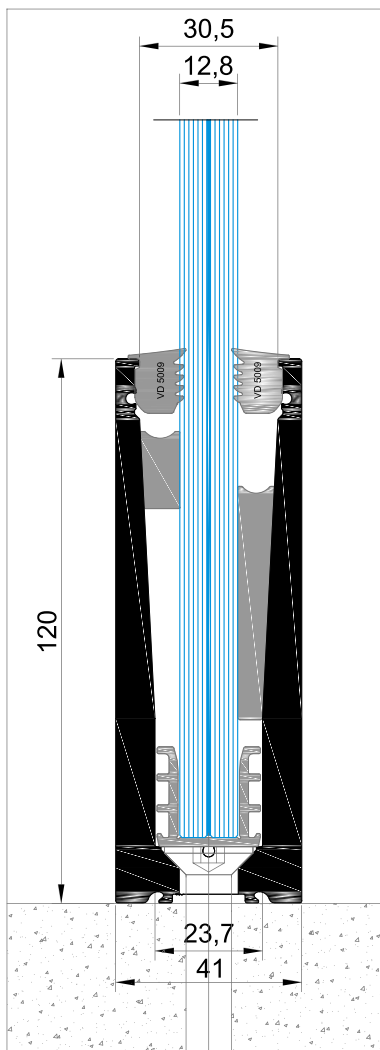

## CAIXA PARA VIDRO DE 16mm (8.8.2) - COM PERFIS BL.35 | 46 | 47

PORMENOR DO PASSA-MÃO BL.51

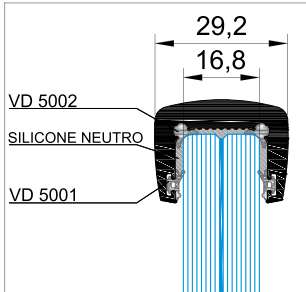

PORMENOR DO PASSA-MÃO U.23

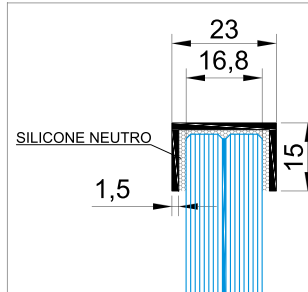

PORMENOR DO PASSA-MÃO U.08

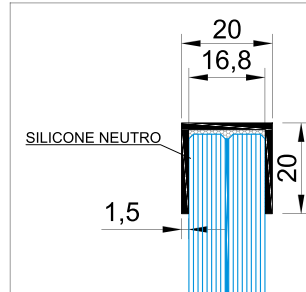

PORMENOR DO PASSA-MÃO U.27

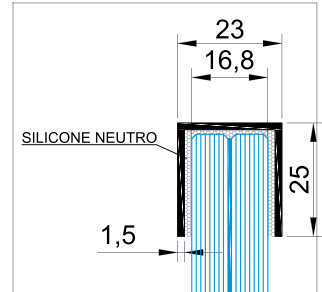

APLICAÇÃO DO SISTEMA NA VERTICAL

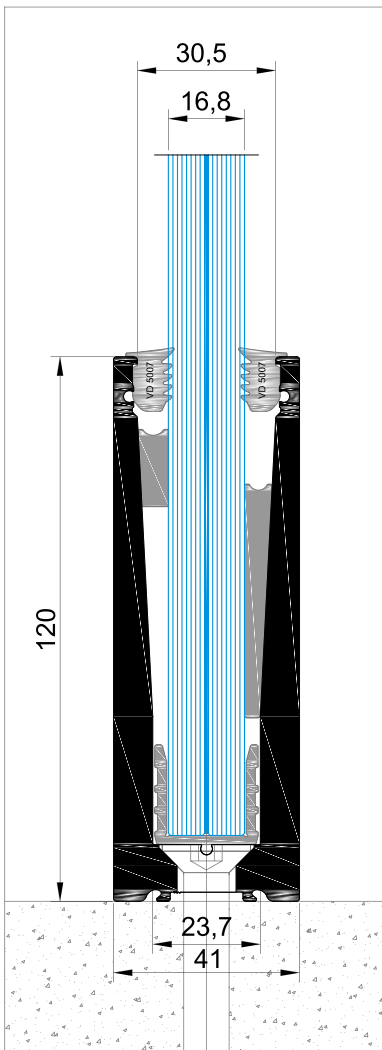

APLICAÇÃO DO SISTEMA NA LATERAL

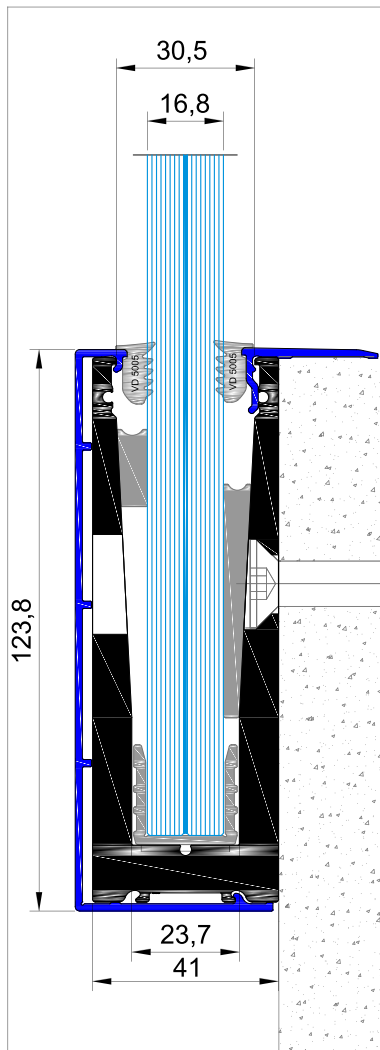

APLICAÇÃO DO SISTEMA EMBUTIDO

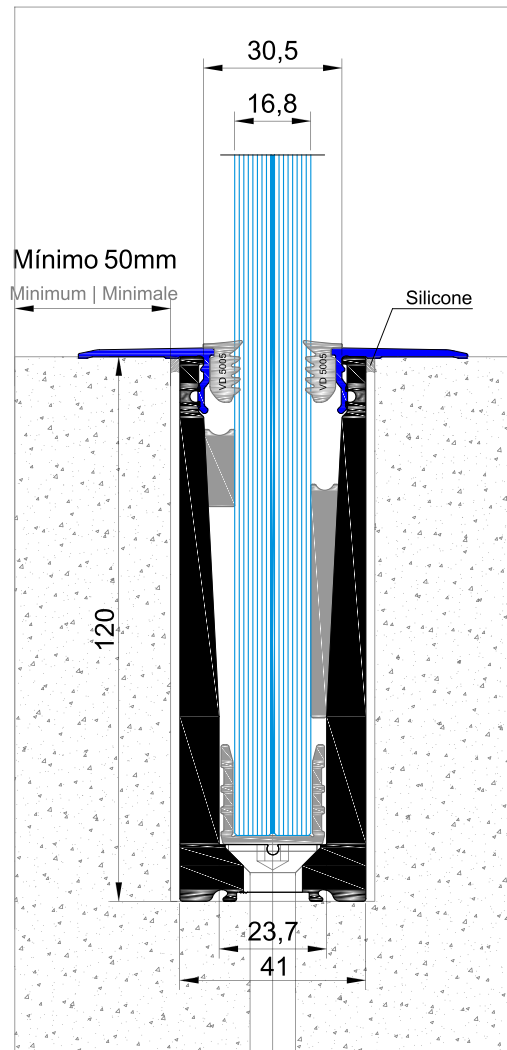

## CAIXA PARA VIDRO DE 20mm (10.10.4) - COM PERFIS BL.35 | 46 | 47

PORMENOR DO PASSA-MÃO BL.52

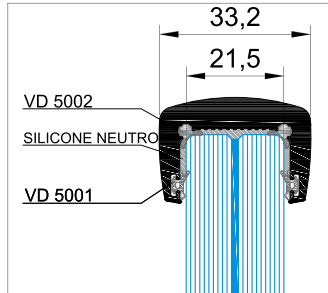

PORMENOR DO PASSA-MÃO U.31

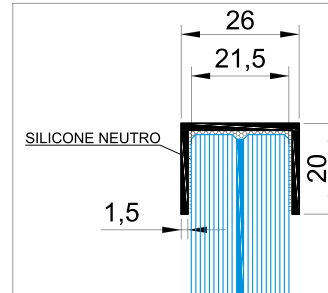

APLICAÇÃO DO SISTEMA NA VERTICAL

APLICAÇÃO DO SISTEMA NA LATERAL

APLICAÇÃO DO SISTEMA EMBUTIDO

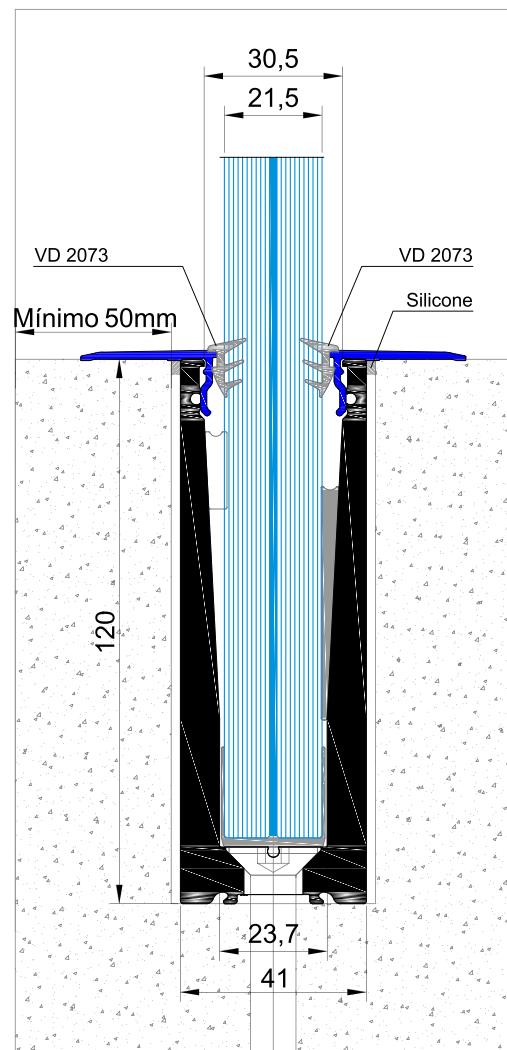
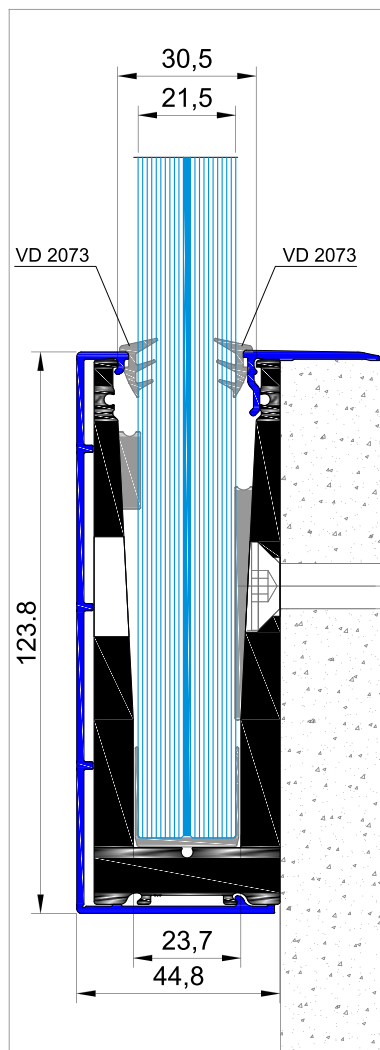
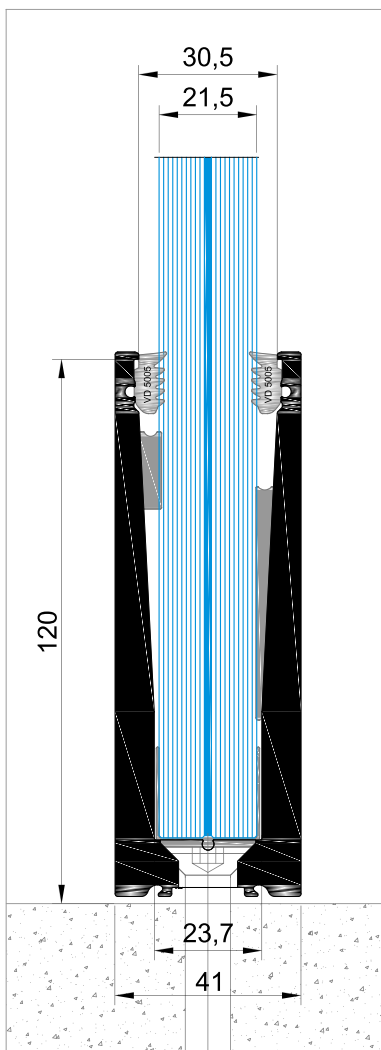

## CAIXA PARA VIDRO DE 12mm (6.6.2) - COM PERFIS BL.53 | 54 | 55

APLICAÇÃO DO SISTEMA NA VERTICAL

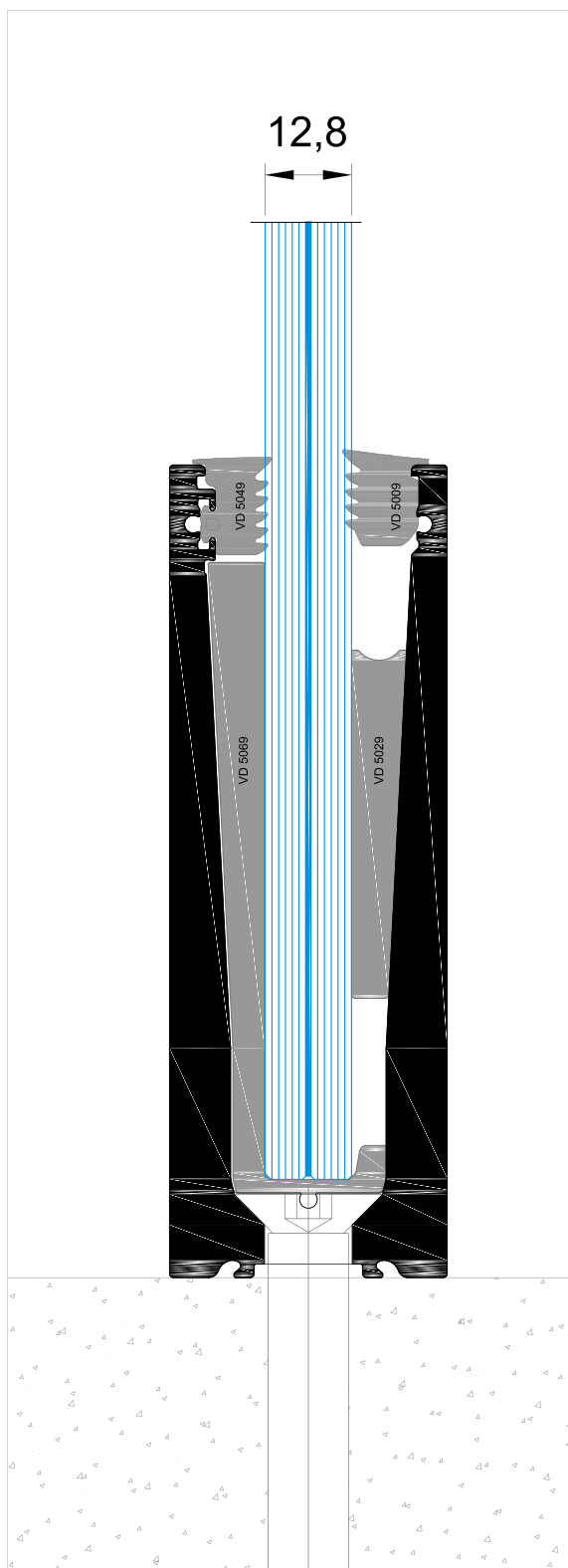

APLICAÇÃO DO SISTEMA NA LATERAL

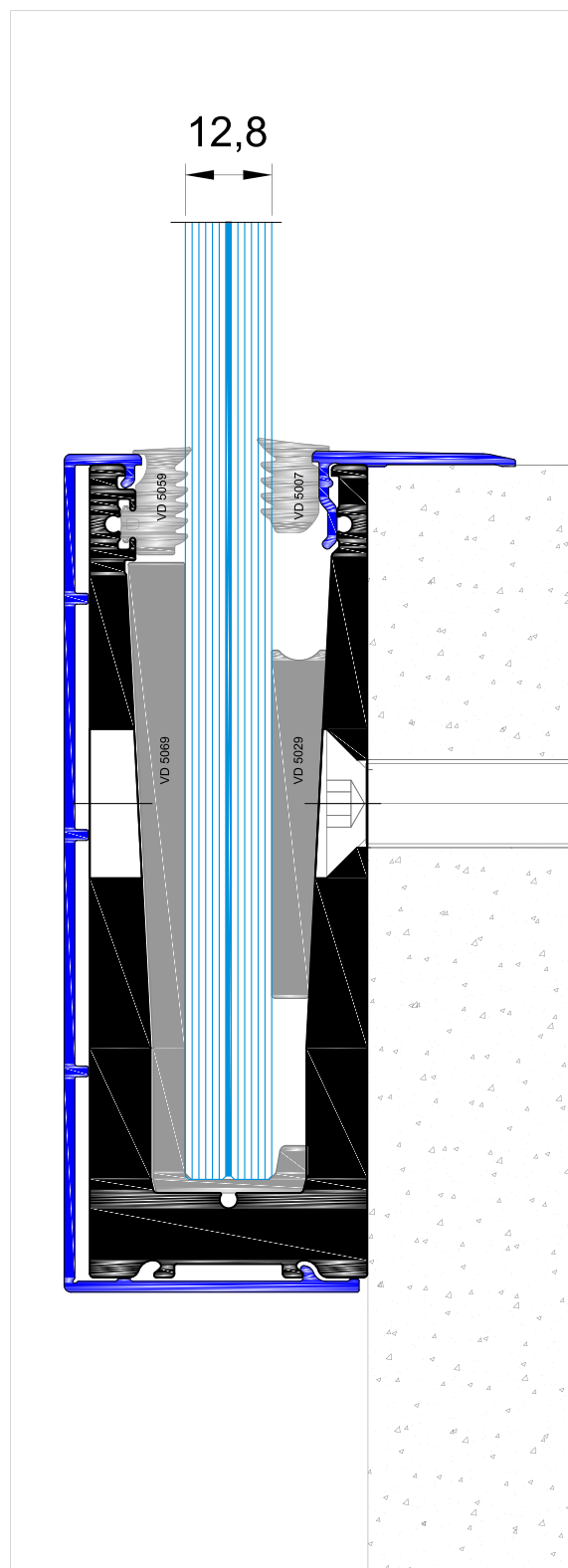

## CAIXA PARA VIDRO DE 16mm (8.8.2) - COM PERFIS BL.53 | 54 | 55

APLICAÇÃO DO SISTEMA NA VERTICAL

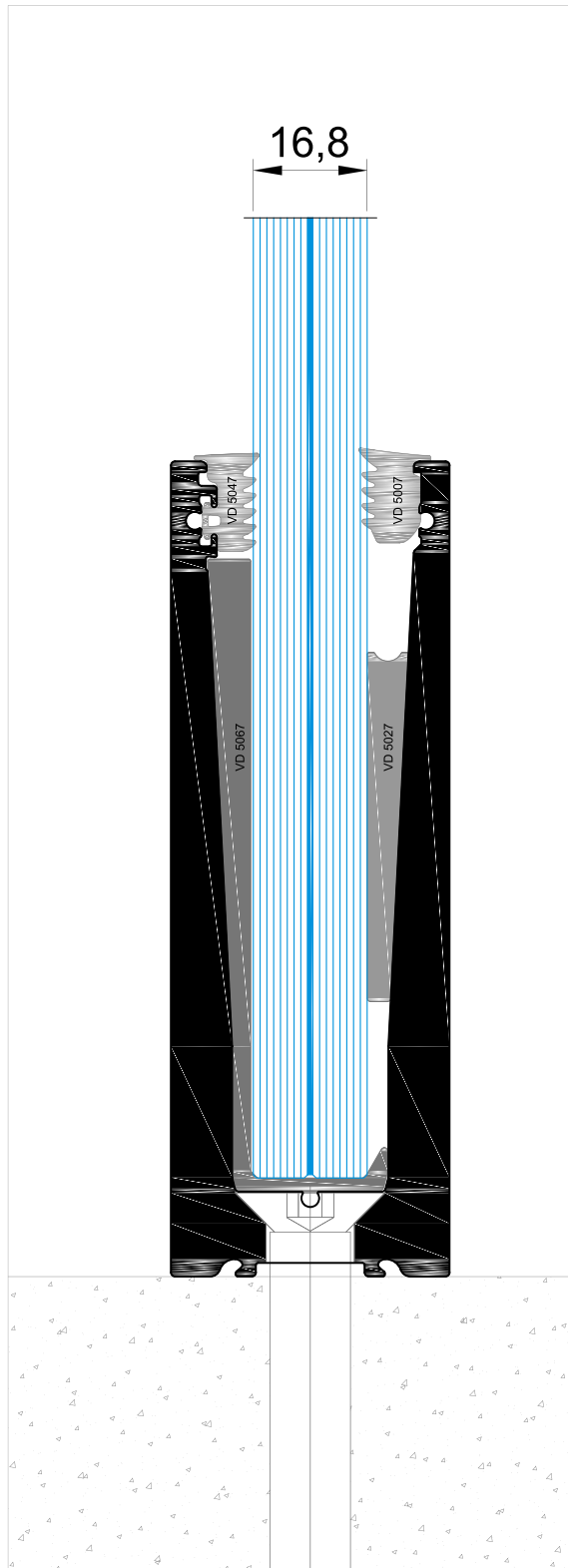

APLICAÇÃO DO SISTEMA NA LATERAL

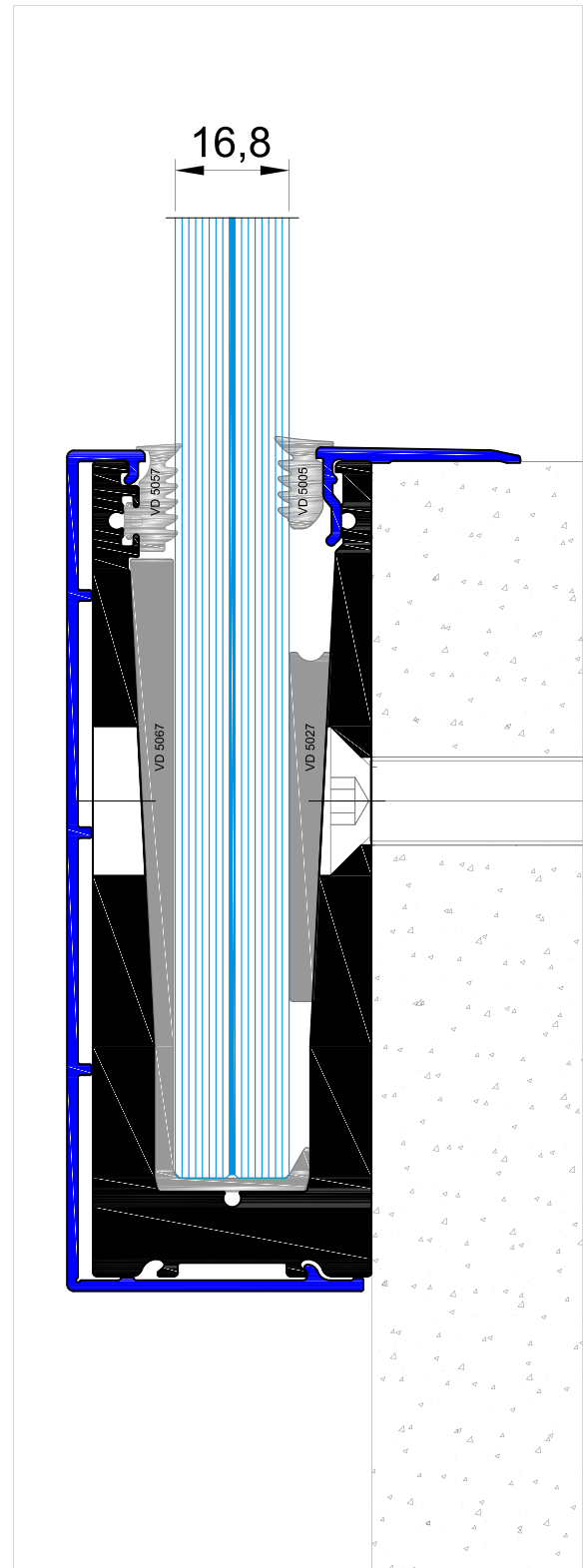

# SÉRIE BL

APLICAÇÃO DO SISTEMA NA VERTICAL  
COM PERFIL U.08  
Para vidro de 16mm (8.8.1)

APLICAÇÃO DO SISTEMA NA VERTICAL  
COM PERFIL U.30  
Para vidro de 16mm (8.8.4)

APLICAÇÃO DO SISTEMA NA VERTICAL  
COM PERFIL U.31  
Para vidro de 20mm (10.10.4)

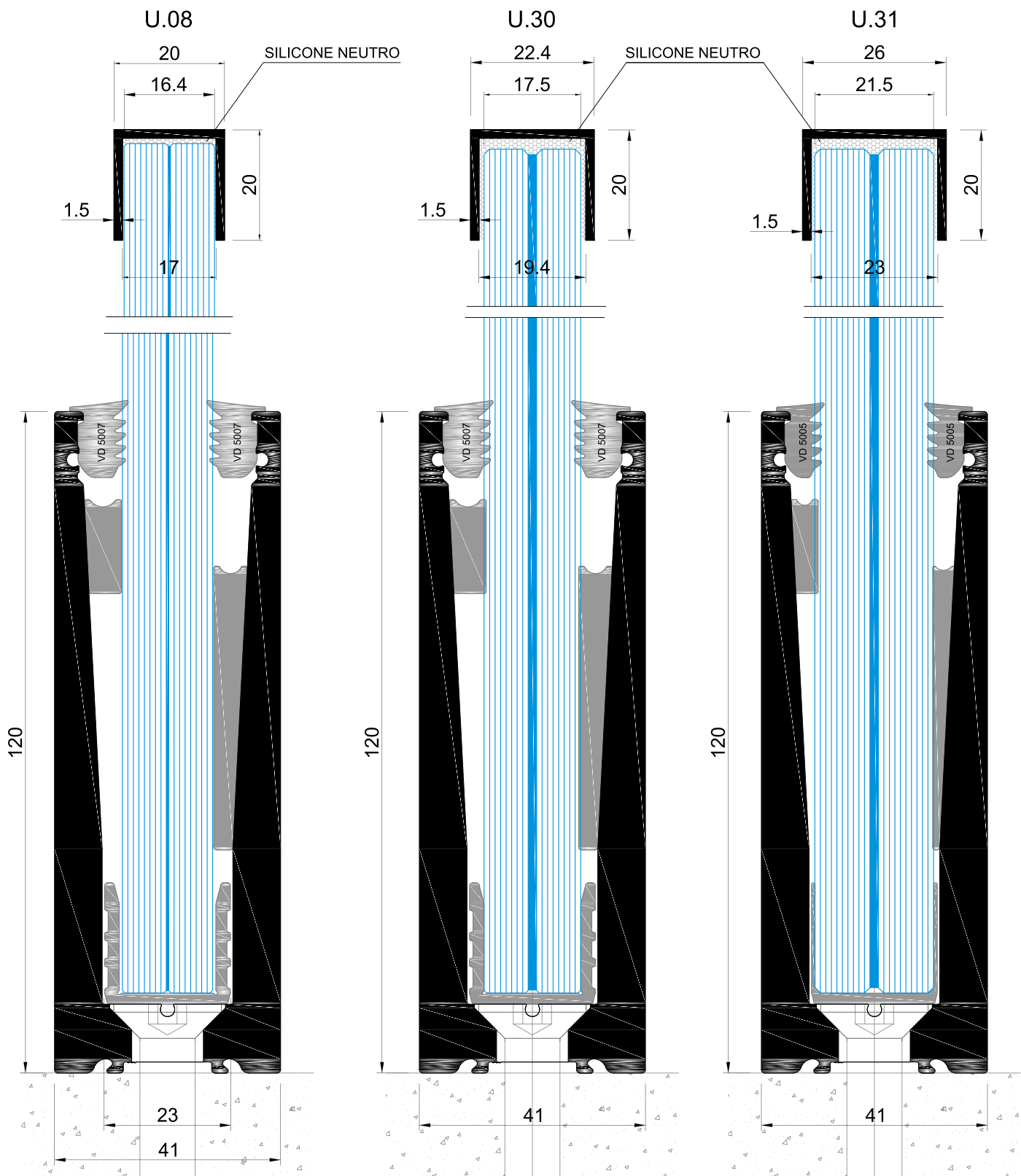



APLICAÇÃO DO SISTEMA NA VERTICAL  
COM PERFIL U.32  
Para vidro de 12mm (6.6.4)

APLICAÇÃO DO SISTEMA NA VERTICAL  
COM PERFIL U.33  
Para vidro de 16mm (8.8.4)

APLICAÇÃO DO SISTEMA NA VERTICAL  
COM PERFIL U.34  
Para vidro de 20mm (10.10.4)

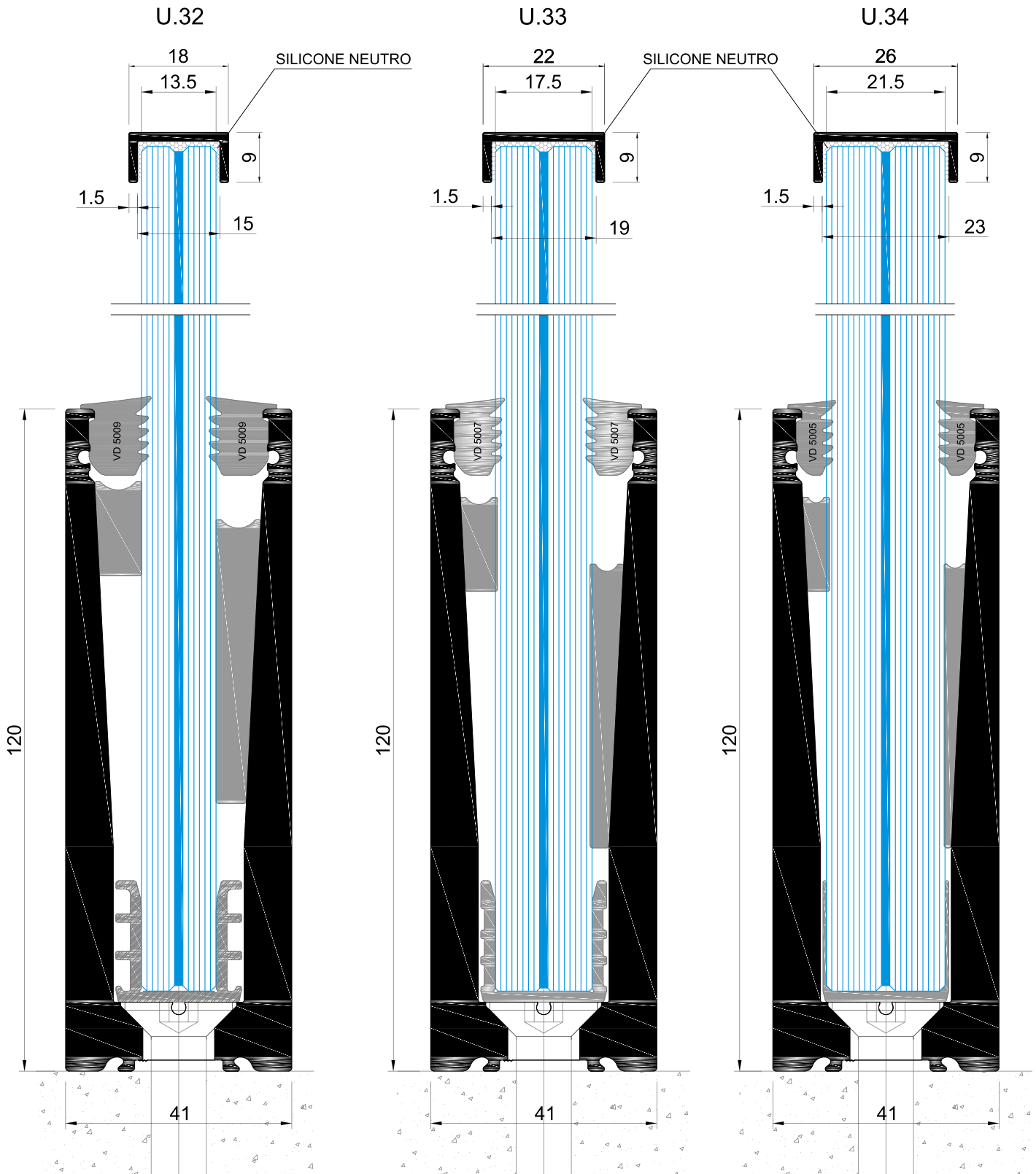







**NORTALU<sup>®</sup>**

📍 Rua Dr. José Bragança Tavares, 78 Fr. A  
4580-593 Paredes(Mouriz)

☎ 255 781 548/49

☎ 92 705 80 65

✉ [nortalu@nortalu.com](mailto:nortalu@nortalu.com)



**[www.nortalu.pt](http://www.nortalu.pt)**



**[www.nortalu.com](http://www.nortalu.com)**



**[www.nortalu.fr](http://www.nortalu.fr)**